

# HELU-S-RK-S-CU-UL

narrow flange

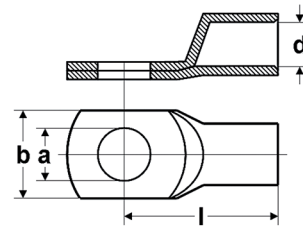

## TECHNICAL DATA

Tubular cable lug

Flange shape Ring shape  
Connecting angle 180° (horizontal)

## ■ STRUCTURE

- Material: copper
- Surface: galvanic tin plated
- uninsulated
- without Inspection hole

## ■ PROPERTIES

- narrow flange

## ■ APPLICATION

- For switchgear with reduced space availability

## ■ NOTES

- Recommended pressing method: WM pressing
- Legend:
  - a - Diameter of stud hole
  - b - Width of flange
  - d - Inner diameter of wire receptable
  - l - Length to centre of hole

Part no.	Cross-sec. mm <sup>2</sup>	Stud hole (M)	Ø Stud hole (a) in mm	Flange width (b) in mm	Ø Wire receptable (d) in mm	Length (l) in mm	Weight in kg/1000 pc.	Packaging unit (in pc.)
90910	35	6	6.5	15.0	8.5	32.0	17.8	25
90911	50	6	6.5	15.0	10.0	37.0	29.5	25
90912	50	8	8.5	17.0	10.0	37.0	28.2	25
90913	50	10	10.5	19.0	10.0	39.0	30.8	25
90914	70	6	6.5	17.0	12.0	43.0	42.2	25
90915	70	8	8.5	17.0	12.0	43.0	41.0	25
90916	70	10	10.5	19.0	12.0	44.0	44.5	25
90917	70	12	13.0	19.0	12.0	46.0	42.2	25
90918	95	6	6.5	19.0	13.5	48.0	54.9	25
90919	95	8	8.5	19.0	13.5	48.0	54.6	25
90920	95	10	10.5	19.0	13.5	48.0	51.3	25
90921	95	12	13.0	19.0	13.5	49.0	51.5	25
90922	120	6	6.5	19.0	15.0	51.0	61.6	10
90923	120	8	8.5	19.0	15.0	51.0	59.4	10
90924	120	10	10.5	19.0	15.0	51.0	58.1	10
90925	120	12	13.0	19.0	15.0	51.0	59.2	10
90926	150	6	6.5	19.0	16.5	56.0	68.5	10
90927	150	8	8.5	19.0	16.5	56.0	68.0	10
90928	150	10	10.5	19.0	16.5	56.0	67.5	10
90929	150	12	13.0	19.0	16.5	57.0	71.5	10
90930	185	10	10.5	24.5	19.0	65.0	105.9	10
90931	185	12	13.0	31.0	19.0	65.0	110.9	10
90932	185	16	17.0	31.0	19.0	65.0	97.6	10
90933	240	10	10.5	31.0	21.0	72.0	127.0	5
90934	240	12	13.0	31.0	21.0	72.0	137.2	5
90935	240	16	17.0	31.0	21.0	72.0	132.8	5

Continued on next page

# HELU-S-RK-S-CU-UL

narrow flange