

KVA-SP

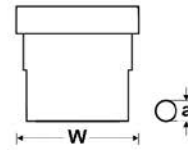

TECHNICAL DATA

PVC sealing insert

Temperature range -20°C to +105°C

■ STRUCTURE

- Material: Soft PVC

■ PROPERTIES

- easy to assemble, time and cost savings
- Large-area sealing

■ APPLICATION

- Machine and plant construction
- Robotics
- Automation technology
- Installation technology
- Control cabinet construction
- For use with KVA gland bodies. Profile fits to ASI-bus line.

■ NOTES

- Legend:
Dimensions
W - Width
a - Diameter of stud hole

Part no.	Size	Size	Sealing insert colour	Packaging unit (in pc.)
97389	PG 11	M20 x 1.5	black / left	100

Part no.	Size	Size	Sealing insert colour	Packaging unit (in pc.)
97396	PG 11	M20 x 1.5	white / right	100