

# KVA-CSP

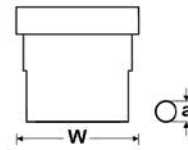

## TECHNICAL DATA

PVC sealing insert

Temperature range -20°C to +105°C

## ■ STRUCTURE

- Material: Soft PVC

## ■ APPLICATION

- Machine and plant construction
- Robotics
- Automation technology
- Vehicle construction and shipbuilding
- Railway technology
- Installation technology
- Control cabinet construction
- For use with KVA gland bodies.

## ■ NOTES

- Legend:  
Dimensions  
W - Width  
a - Diameter of stud hole

Part no.	Size	Size	Sealing insert colour	Packaging unit (in pc.)
97087	PG 9	M16 x 1.5	white	100
97088	PG 11		white	100
97089	PG 13.5	M20 x 1.5	white	100
97090	PG 16	M25 x 1.5	white	50
97091	PG 21	M32 x 1.5	white	50

Part no.	Size	Size	Sealing insert colour	Packaging unit (in pc.)
97092	PG 29	M40 x 1.5	white	25
97093	PG 36	M50 x 1.5	white	25
97094	PG 42		white	10
97095	PG 48	M63 x 1.5	white	10