

HSSV IP68 elbow 90°

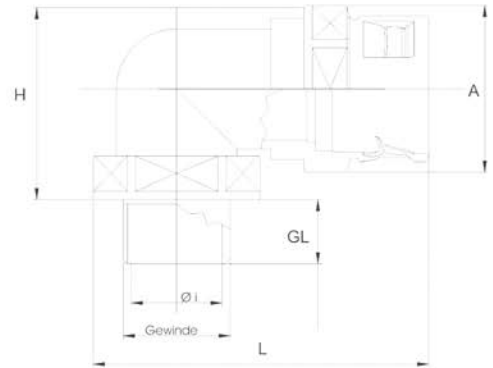

TECHNICAL DATA

Quick-insert corrugated tubes conduit gland - elbow 90°

Temperature range -40°C to +110°C
Protection class IP 65

STRUCTURE

- Material: Polyamide (PA) 6
- Flammability acc. to UL 94 (V0)

PROPERTIES

- halogen-free
- cadmium-free
- resistant to: fuels, mineral oils, greases, weak bases, weak acids

APPLICATION

- Machine and plant construction
- Robotics
- Automation technology
- Vehicle construction and shipbuilding
- Railway technology
- Installation technology
- Control cabinet construction
- Quick-insert glands for a reliable, quick connection. Suitable for parallel-coiled HELUcond protection tubes.

NOTES

- Interior seal made of TPE.
- Threaded connection: metric to EN 60423
- Each unit includes 1 safety opener

metric thread

Size	Suitable for nominal size	Thread length mm	Packaging unit (in pc.)	grey	black
				Part no.	Part no.
M12 x 1.5	10.0	9.5	50	920422	920431
M16 x 1.5	10.0	9.0	50	920423	920432
M16 x 1.5	12.0	8.0	50	920424	920433
M20 x 1.5	17.0	10.5	50	920425	920434
M25 x 1.5	21.0 / 23.0	14.8	50	920426	920435
M32 x 1.5	29.0	13.8	25	920427	920436
M40 x 1.5	36.0 / 37.0	15.6	25	920428	920437
M50 x 1.5	48.0 / 50.0	16.0	10	920429	920438
M63 x 1.5	48.0 / 50.0	15.5	10	920430	920439