

WVF

for simple cable insertion

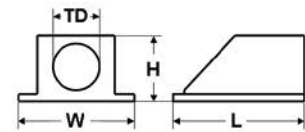

TECHNICAL DATA

Zinc elbow flange

Temperature range -20°C to +100°C
Protection class IP 68 - 10 bar

■ STRUCTURE

- Material: Zinc die casting
- O-ring: Chloroprene rubber (CR)

■ APPLICATION

- Machine and plant construction
- Robotics
- Automation technology
- Vehicle construction and shipbuilding
- Railway technology
- Installation technology
- Control cabinet construction

■ NOTES

- Legend:
Dimensions
TD - Thread Diameter
H - Height
W - Width
L - Length

metric thread – female

Part no.	Size inside	Height mm	Width mm	Length mm	Packaging unit (in pc.)
91730	M20 x 1.5	35	53	56	10
91731	M25 x 1.5	42	63	65	10
91732	M32 x 1.5	52	70	75	5

Part no.	Size inside	Height mm	Width mm	Length mm	Packaging unit (in pc.)
91733	M40 x 1.5	52	71	75	5
91734	M50 x 1.5	69	89	93	2
91735	M63 x 1.5	74	96	114	1

PG thread – female

Part no.	Size inside	Height mm	Width mm	Length mm	Packaging unit (in pc.)
92930	PG 9	30	45	48	10
92931	PG 11	30	45	48	10
92932	PG 13.5	35	53	56	10
92933	PG 16	35	53	56	10
92934	PG 21	42	63	65	5

Part no.	Size inside	Height mm	Width mm	Length mm	Packaging unit (in pc.)
92935	PG 29	52	71	75	5
92936	PG 36	69	89	94	2
92937	PG 42	74	96	114	1
92938	PG 48	74	96	114	1