

B-PF

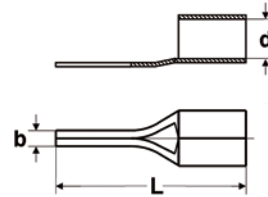
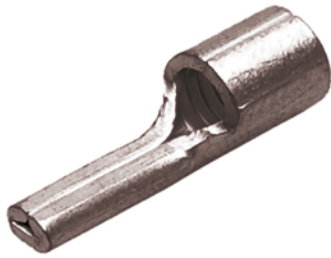

TECHNICAL DATA

Crimp cable lug

Flange shape

Pin shape

Temperature range

up to +120°C

■ STRUCTURE

- Material: copper
- Surface: galvanic tin plated
- uninsulated
- without Inspection hole

■ APPLICATION

- Non-insulated squeeze snap-on connection in pin design.

■ NOTES

- Standardised to DIN 46230 up to 16mm².
- Legend:
Dimensions
a - Diameter of stud hole
b - Width of flange
d - Inner diameter of wire receptacle
L - Length

Part no.	Type	Cross-sec. mm ²	∅ Stud hole (a) in mm	Flange width (b) in mm	Length (l) in mm	Weight in kg/1000 pc.	Packaging unit (in pc.)
91556	B 0.5P	0.50 - 1.50	10.0	1.9	17.0	0.6	100
91557	B 2.5P	1.50 - 2.50	10.0	1.9	17.0	0.7	100
91558	B 6P	4.00 - 6.00	11.0	2.7	20.0	1.6	100
91559	B 10P	10.00	11.0	4.3	24.5	2.7	100
91560	B 16P	16.00	15.0	5.8	29.5	3.9	100
91378	B 25P	25.00	15.0	6.8	33.5	6.3	1
91379	B 35P	35.00	20.0	8.0	40.5	11.7	1
91380	B 50P	50.00	20.0	9.5	45.0	17.9	1
91381	B 70P	70.00	23.0	11.0	55.0	28.2	1
91377	B 95P	95.00	23.0	12.5	55.0	43.0	1