

HELU-S-RK-CU

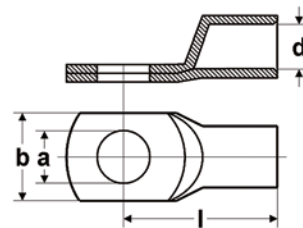

TECHNICAL DATA

Tubular cable lug

Flange shape Ring shape
 Connecting angle 180° (horizontal)
 Temperature range up to +120°C

■ STRUCTURE

- Material: copper acc. to DIN EN 13600
- Surface: galvanic tin plated

- uninsulated
- without Inspection hole

■ NOTES

- Recommended pressing method: WM pressing
- Legend:
 - a - Diameter of stud hole
 - b - Width of flange
 - d - Inner diameter of wire receptable
 - l - Length to centre of hole

Part no.	Cross-sec. mm ²	Stud hole (M)	∅ Stud hole (a) in mm	Flange width (b) in mm	∅ Wire receptable (d) in mm	Length (l) in mm	Weight in kg/1000 pc.	Packaging unit (in pc.)
907303	0.75	3	3.2	6.5	1.4	12.5	0.7	100
907304	0.75	4	4.3	8.5	1.4	14.0	0.8	100
907305	0.75	5	5.3	10.0	1.4	15.0	1.0	100
907306	1.5	3	3.2	6.5	1.9	14.0	1.2	100
907307	1.5	4	4.3	8.5	1.9	15.0	1.4	100
907309	1.5	6	6.4	11.0	1.9	18.0	1.7	100
907311	2.5	5	5.3	10.0	2.4	16.0	1.8	100
907312	2.5	6	6.4	11.0	2.4	18.0	1.9	100
907313	2.5	8	8.4	13.0	2.4	20.0	2.2	100
907314	4	4	4.3	8.5	3.0	17.0	2.2	100
907315	4	5	5.3	10.0	3.0	18.0	2.4	100
907316	4	6	6.3	11.0	3.0	20.0	2.6	100
907317	4	8	8.4	14.0	3.0	22.0	3.0	100
907403	500	12	13.0	55.5	31.0	113.0	493.8	5
907406	630	16	17.0	60.0	34.0	115.0	513.5	5
907407	630	20	21.0	60.0	34.0	115.0	506.0	5