

# UNI-DICHT MFDE

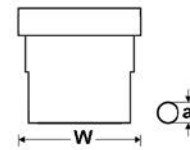

## TECHNICAL DATA

TPE multiple sealing insert

Temperature range -40°C to +130°C

### ■ STRUCTURE

- Material: thermoplastic elastomers (TPE)

### ■ PROPERTIES

- halogen-free
- phosphor-free
- silicone-free
- cadmium-free

### ■ APPLICATION

- Machine and plant construction
- Robotics
- Automation technology
- Vehicle construction and shipbuilding
- Railway technology
- Installation technology
- Control cabinet construction
- For use with UNI-DICHT gland bodies made by polyamide or by brass.

### ■ NOTES

- The UNI-DICHT sealing inserts M20x1,5 (part no. 904004 up to 904010) can be used only with UNI-DICHT gland body made by polyamide M20x1,5 (part no. 90831).
- The UNI-DICHT sealing inserts M20x1,5 (part no. 904011 up to 904017) can be used with UNI-DICHT-VK-MS M20x1,5 (Art.-Nr. 904213), UNI-DICHT-VK-PA PG13,5 (part no. 96045) and UNI-DICHT-VK-MS PG13,5 (part no. 904223).
- Legend:  
Dimensions  
W - Width  
a - Diameter of stud hole

Part no.	Size	Size	Sealing insert colour	Number holes x cable-Ø mm	Packaging unit (in pc.)
903994	PG 9	M16 x 1.5	white	2 x 1.2	100
903995	PG 9	M16 x 1.5	white	2 x 3.0	100
903996	PG 9	M16 x 1.5	white	4 x 3.0	100
903997	PG 9	M16 x 1.5	white	2 x 4.0	100
903998	PG 9	M16 x 1.5	white	1 x 5.0	100
904006		M20 x 1.5	white	2 x 3.0	100
904007		M20 x 1.5	white	3 x 3.0	100
904008		M20 x 1.5	white	3 x 4.0	100
904009		M20 x 1.5	white	2 x 5.0	100
904010		M20 x 1.5	white	2 x 6.0	100
904000	PG 11	M20 x 1.5	white	2 x 3.0	100
904001	PG 11	M20 x 1.5	white	3 x 3.0	100
904002	PG 11	M20 x 1.5	white	2 x 4.0	100
904003	PG 11	M20 x 1.5	white	2 x 5.0	100
904012	PG 13.5	M20 x 1.5	white	10 x 2.0	100
904013	PG 13.5	M20 x 1.5	white	2 x 3.0	100
904014	PG 13.5	M20 x 1.5	white	3 x 3.0	100
904015	PG 13.5	M20 x 1.5	white	3 x 4.0	100
904017	PG 13.5	M20 x 1.5	white	2 x 6.0	100

Part no.	Size	Size	Sealing insert colour	Number holes x cable-Ø mm	Packaging unit (in pc.)
904018	PG 16	M25 x 1.5	white	7 x 2.0	100
904019	PG 16	M25 x 1.5	white	3 x 3.0	100
904020	PG 16	M25 x 1.5	white	2 x 4.0	100
904021	PG 16	M25 x 1.5	white	4 x 4.0	100
904022	PG 16	M25 x 1.5	white	6 x 4.0	100
904023	PG 16	M25 x 1.5	white	2 x 6.0	100
904024	PG 16	M25 x 1.5	white	3 x 6.0	100
904025	PG 16	M25 x 1.5	white	4 x 6.0	100
904026	PG 16	M25 x 1.5	white	3 x 7.0	100
904027	PG 16	M25 x 1.5	white	2 x 8.0	100
904028	PG 21	M32 x 1.5	white	21 x 2.0	50
904030	PG 21	M32 x 1.5	white	6 x 4.0	50
904031	PG 21	M32 x 1.5	white	8 x 4.0	50
904032	PG 21	M32 x 1.5	white	4 x 5.0	50
904033	PG 21	M32 x 1.5	white	8 x 5.0	50
904034	PG 21	M32 x 1.5	white	6 x 5.5	50
904035	PG 21	M32 x 1.5	white	4 x 6.0	50
904036	PG 21	M32 x 1.5	white	4 x 6.5	50
904037	PG 21	M32 x 1.5	white	6 x 6.5	50

Continued on next page

# UNI-DICHT MFDE

Part no.	Size	Size	Sealing insert colour	Number holes x cable-Ø mm	Packaging unit (in pc.)
904038	PG 21	M32 x 1.5	white	3 x 7.0	50
904039	PG 21	M32 x 1.5	white	2 x 8.0	50
904040	PG 21	M32 x 1.5	white	4 x 8.0	50
904041	PG 21	M32 x 1.5	white	2 x 9.0	50
904042	PG 21	M32 x 1.5	white	3 x 9.0	50
904044	PG 29	M40 x 1.5	white	10 x 6.0	25
904043	PG 29	M40 x 1.5	white	6 x 6.0	25
904045	PG 29	M40 x 1.5	white	4 x 6.5	25
904046	PG 29	M40 x 1.5	white	7 x 7.0	25
904047	PG 29	M40 x 1.5	white	6 x 8.0	25
904048	PG 29	M40 x 1.5	white	4 x 9.0	25
904049	PG 29	M40 x 1.5	white	5 x 9.0	25

Part no.	Size	Size	Sealing insert colour	Number holes x cable-Ø mm	Packaging unit (in pc.)
904050	PG 29	M40 x 1.5	white	5 x 10.0	25
904051	PG 29	M40 x 1.5	white	2 x 11.0	25
904052	PG 29	M40 x 1.5	white	3 x 11.0	25
904053	PG 29	M40 x 1.5	white	2 x 13.0	25
904054	PG 36	M50 x 1.5	white	15 x 5.0	10
904055	PG 36	M50 x 1.5	white	13 x 7.0	10
904056	PG 36	M50 x 1.5	white	7 x 9.0	10
904057	PG 36	M50 x 1.5	white	8 x 9.0	10
904058	PG 36	M50 x 1.5	white	3 x 10.0	10
904059	PG 36	M50 x 1.5	white	4 x 13.0	10
904060	PG 36	M50 x 1.5	white	2 x 15.0	10